

**DIRECTIONS TO NATUREZA VIVA NURSERY**  
**25651 SW 154 Avenue, Princeton, FL 33032**  
**(305) 248-2068**

---

**From ForemostCo<sup>®</sup> /Miami: (takes about 1 hour from the office)**

- 1) Right on NW 84th Ave, then right on NW 58th St to NW 87th Ave
- 2) Left on NW 87th Ave, then right on NW 36th St (just after Doral).
- 3) West to Florida turnpike (NW 36th St turns into NW 41st St at some point).
- 4) South on Florida Turnpike 15 miles (past Tamiami Trail, Kendall Drive, Coral Reef Dr, Eureka Drive) to Caribbean Blvd (approx. 204<sup>th</sup> st). Exit and turn right.
- 5) At the second set of lights (about 1/4 mile) turn left onto U.S. 1. Travel south past the Southland Mall to Coconut Palm Dr, SW 248th Street. Turn right onto SW 248th.  
(\*Note: You will see an AMOCO gas station on the left side of U.S.1 as you turn right).
- 6) Go west to Kingman Dr, which is SW 152 Ave-turn left.
- 7) The next intersection turn right on Plummer Dr, which is SW 256th St.
- 8) Nursery is about 1/4 mile down on the left-SE corner of SW 256th St and SW 154 Ave. Look for a tall Ficus hedge with a green gate.
- 9) Don't hesitate to call if you get lost!

**From north and west of Miami:**

- 1) Come down U.S. 27 to Krome Ave (S.R.997) or east from Naples and US 41 to Krome Avenue. Follow signs toward Homestead.
- 2) Pass Tamiami Trail (Miccosukee Indian Casino) and Kendall Dr-go down a good distance.
- 3) Turn left at Coconut Palm, which is SW 248th St. (you will see a Texaco on the left as you turn).
- 4) Go to Kingman Dr, which is SW 152 Ave. Turn right.
- 5) Follow directions #7-9 above.

**From TPIE/Ft. Lauderdale Convention Center:**

- 1) Go west on I-595 to Florida's Turnpike.
- 2) Go south 8 miles - follow signs to Florida Turnpike/Homestead Extension.
- 3) Go south on Florida Turnpike/Homestead Extension 25 miles to Caribbean Blvd.
- 4) Follow #5-9 above.

[MAP ON NEXT PAGE:](#)



# Directions to Natureza Viva Nursery

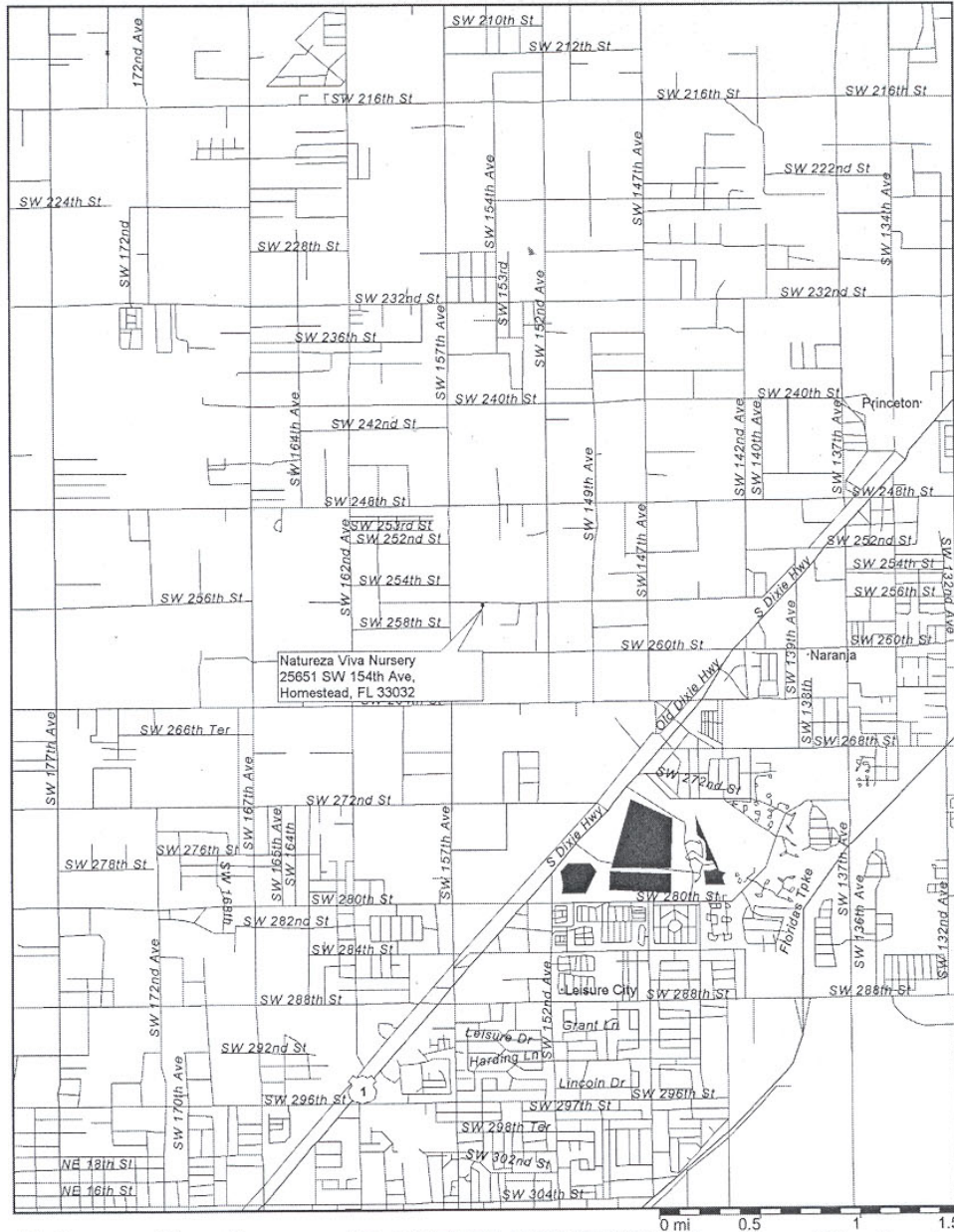

**Natureza Viva Nursery (Sold EXCLUSIVELY by ForemostCo, Inc.)  
25651 SW 154th Street, Princeton, FL 33032**

**Ph: 305-248-2068 • ForemostCo Ph: 800-421-8986 • E-mail: Sales@foremostco.com**

Take the Florida Turnpike SOUTH and get off at Caribbean drive. When you are on the Caribbean drive exit, go WEST. You will head WEST on Caribbean drive for about 1/4 of a mile where you will go SOUTH on US1. Take US1 SOUTH till you get to SW 248th Street (Coconut Palm Drive) where you will make a RIGHT (West). Continue on SW 248th (Coconut Palm) till you get to 152nd Ave (Kingman Ave) and make a LEFT (South). Continue on 152nd Ave (Kingman Ave) till you get to 256th St. (Plummer) and make a RIGHT. Continue on 256th Street for about 1/4 of a mile, the nursery will be on the left (the SE corner of 256th and 154th) . Enter in the green gate in the center of the tall Ficus Hedge.